

Installation Notes

Elmguard Street

Street Light & Fixture Notes:

- 19 Street Light poles to be installed 5ft. off side of curb as per sketch
- Street Light poles to be installed on a pre-formed base at a burial depth of 4ft. (see Composite Burial Foot specifications).
- One (1) 60lb bag of concrete mix (dry) shall be used at each pole base prior to backfill.
- Suitable back fill material to be used and tamped.
- 19 Street Light Post-Top fixtures (harp) to be installed per manufacturer specifications with photo control eyes facing north. (Lighting system @ 120volts)
- All connections within light fixtures shall be per manufacturer specifications.
- All Street Light poles shall be tagged in field per sketch.

Underground Cable Notes:

- Install 3- #6 THHN cable (1,150ft. +/-) from RG&E pole # 15 W. Ridge Rd. to Town of Greece Hand Hole (installed < 50ft. from RG&E pole) and between light pole number E1 and E18.
- Install 3- #10 THHN stranded copper cable and KTK type fuse kit (15amp) in pole hand hole from base to new fixture.
- One six (6) foot section of 1 1/2 in. SCH 40 riser shall be installed at RG&E pole # 15 West Ridge Rd. All underground wire shall "feed through" sweeps at each composite burial foot
- All electrical connections within composite burial foot and pole shall be compression type with mastic tape wrap suitable for underground conditions.
- Fuse with 60amp KTK type fuse kits each hot leg located in Town of Greece Hand Hole.

Street Light Excavation Notes:

- All excavation shall be completed within the Town of Greece ROW. The contractor is responsible for and maintaining all required stakeouts and any damages to existing underground utilities.
- All excavation shall be completed with minimal impact to residential property and no open trench shall be left over night.
- All trench for conduit installation shall be at a 24in. depth and located per sketch. Suitable backfill material is required and shall be tamped with damage to the 1 1/2 in. SCH 40 PVC.
- All driveway crossings shall be "pushed" at a 24in. depth with 1 1/2 in. galvanized conduit per sketch
- No open cuts shall be made on customer driveways and/or roadway
- All 1 1/2 in. SCH 40 PVC and sweep joints shall be glued.
- Contractor is responsible for all excavation restoration to include finish grade and seed with screened topsoil.

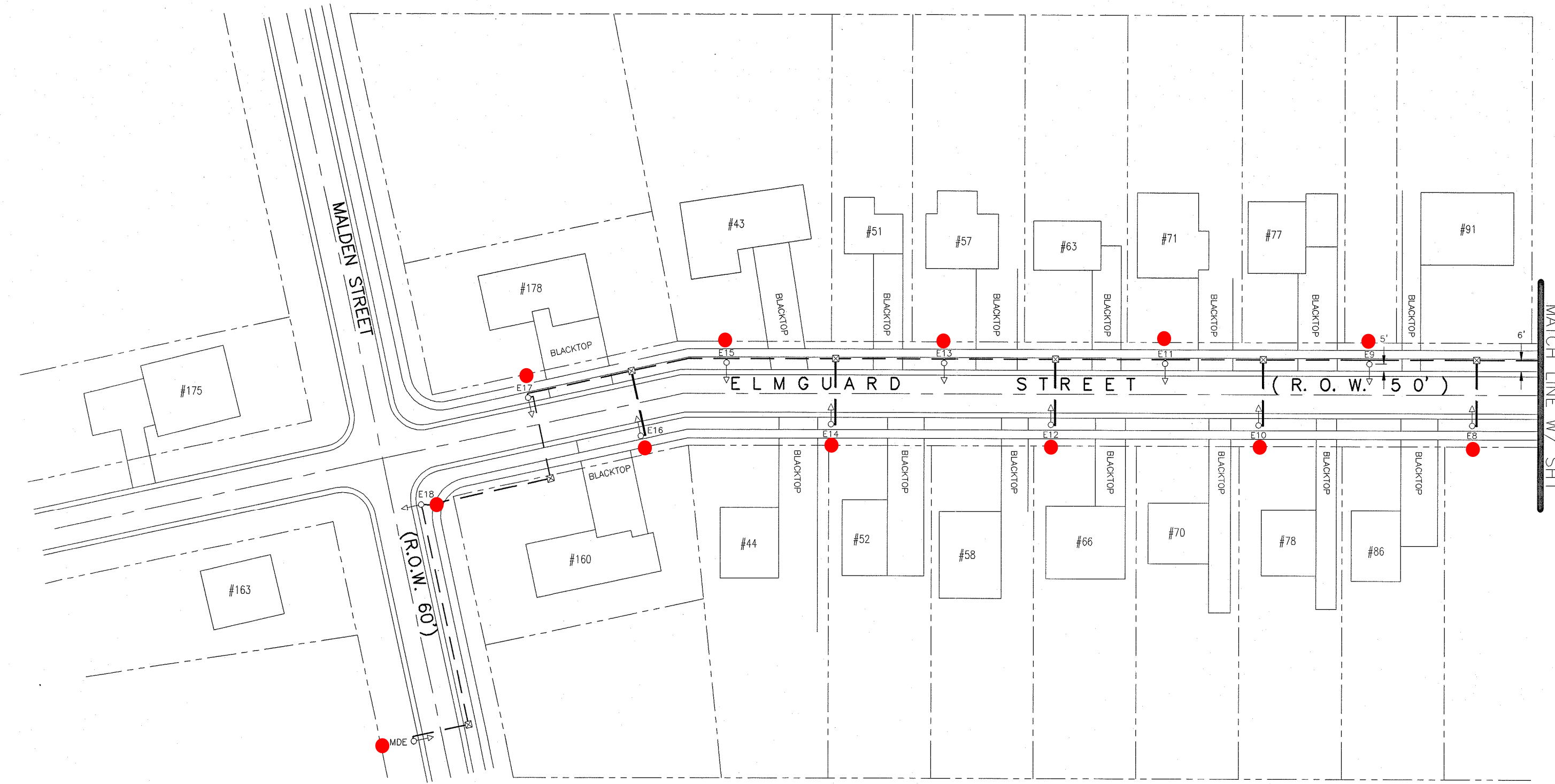

EXISTING PAD MOUNT



NEW POLE



NEW FIXTURE



HAND HOLE



CONDUIT



PROJECT NAME
**ELMGUARD STREET
DECORATIVE LIGHTING
INSTALLATION**

DATE	REVISION	BY

CLIENT

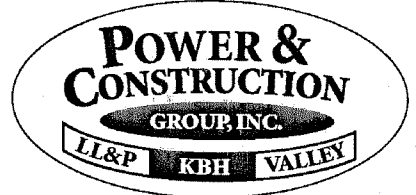

96 RIVER ROAD
PO BOX 198
ROCHESTER, NY 14546
585-889-6016



Updates & Designs, Inc.
1749 Scottsville Road
Rochester, NY 14623
(585) 328-7897

DESIGNED BY: S. SMYTHE

DRAWN BY: UDI-BT

CHECKED BY: S. SMYTHE

APPROVED BY: S. SMYTHE

AS-BUILT:

PROJECT NO. LLP8000SS

SCALE: 1"=50'

DATE: 8/11/08

DWG. NO
SH2
SHEET 2 OF 2